

SIZE CHART

	A	B*	C	D	E WELDING CONTROLS	E SOFT TOUCH
I	16	16	9	17.3	11	11
II	20	20	9.5	21.3	16.5	15
III	24	24	9.5	25.3	18	-
IV	30	30	13	31.3	28.5	-
V	36	30	13	37.3	28.5	-
VI	36	36	13	37.3	34.5	-

C	18" WAS 22.5"	3/22/24	
B	ADDED SOFT TOUCH	2.22.23	
A	11" WAS 14.4"	1.7.19	
REV.	DESCRIPTION	BY	DATE
UNITROL ELECTRONICS, INC. 702 Landwehr Road Northbrook, Illinois 60062			
DATE: 4/18/08	SCALE:	APPROVED BY: R. HIRSCH	DRAWN BY: SD
CONTROL ENCLOSURES			
NEMA-4			DWG. NO. 1995C

*Add 1.3" for controls with option #9181-42 FLANGE OPERATED CIRCUIT BREAKER

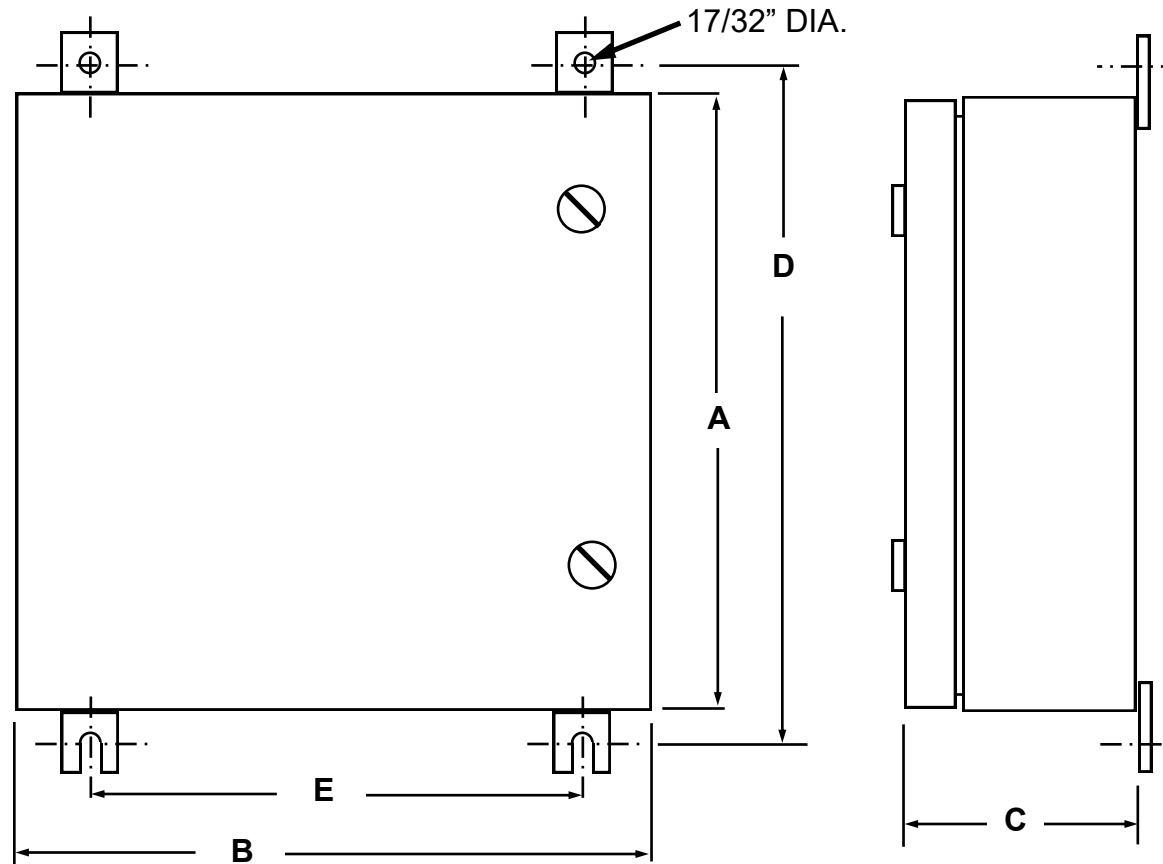

SIZE CHART

	A	B*	C	D	E WELDING CONTROLS	E SOFT TOUCH
I	16	16	9	17.3	11	11
II	20	20	9.5	21.3	16.5	15
III	24	24	9.5	25.3	18	-
IV	30	30	13	31.3	28.5	-
V	36	30	13	37.3	28.5	-

*Add 1.3" for controls with option #9181-42 FLANGE OPERATED CIRCUIT BREAKER

REV.	DESCRIPTION	BY	DATE
UNITROL ELECTRONICS, INC. 702 Landwehr Road Northbrook, Illinois 60062			
DATE: 4/18/08	SCALE: NONE	APPROVED BY: R. HIRSCH	DRAWN BY: SD
CONTROL ENCLOSURES			
NEMA-4			DWG. NO. 1995C